

APPENDIX 1

Transport for Buckinghamshire

Buckinghamshire County Council

Transport Economy Environment

Aylesbury Vale Area Office
Corrib Industrial Park,
Griffin Lane,
Aylesbury
Buckinghamshire
HP19 8BP

Contract Director
Louise McCann

To the Occupier

Telephone 01296 382416

Email parkingtro@buckscc.gov.uk

www.buckscc.gov.uk

Date: 20th December 2019

Ref: Malthouse / Barley Way Parking
Restrictions

Dear Resident

Statutory Consultation for introduction / amendment to parking restrictions in Malthouse Way / Barley Way, Marlow

Transport for Buckinghamshire has been commissioned by Buckinghamshire County Council to review and propose additional parking restrictions in Malthouse Way / Barley Way, Marlow.

We are now commencing with the Statutory Consultation for the introduction of the above proposed measures. A copy of the Orders and Plans showing the lengths of road affected, together with a copy of the Council's Statement of Reasons for proposing to make the Order may be inspected during normal opening hours at County Hall, Walton Street, Aylesbury, HP20 1UA. Details of how to object to the proposals, or comments in support, can be found below:

Objections to the proposal together with the grounds on which they are made, or expressions of support must be sent in writing by 24th January 2020 to the Network Improvement Team, Buckinghamshire County Council, Transport Economy Environment, Aylesbury Vale Area Office, Corrib Industrial Park, Griffin Lane, Aylesbury, Buckinghamshire HP19 8BP or by email to parkingtro@buckscc.gov.uk or online at www.buckscc.gov.uk/haveyoursay.

Under the Local Government (Access to Information) Act 1985 this Council is obliged to make any representations received in response to this notice, open to public inspection.

If you have any further questions about the proposed measures, or require assistance to take part, please call our contact centre on 01296 382416.

Yours sincerely



Johnathon Sahota
Project Engineer
Network Improvement Team

APPENDIX 1

THE BUCKINGHAMSHIRE COUNTY COUNCIL
(WYCOMBE DISTRICT) (CONSOLIDATION) ORDER 2014
(* 20) (AMENDMENT No.*) ORDER 20****

Notice is hereby given that Buckinghamshire County Council proposes to make the above-named Order under the Road Traffic Regulation Act 1984.

The effect of the Order is to introduce short sections of 'no waiting at any time' (double yellow lines) restriction on the following lengths of road:

- a) On the bends on Barley Way in the vicinity of Nos. 1 and 10
- b) On the bends on Barley Way opposite Nos. 23, 24, 25 and 26
- c) On Barley Way for a short stretch opposite No. 16.
- d) On Malthouse Way in the vicinity of the entrance to the gated parking

A copy of the Order and Plans showing the lengths of road affected, together with a copy of the Council's Statement of Reasons for proposing to make the Order can be viewed on the Buckinghamshire County Council website under 'About your Council' click 'Have your say' then click 'view all opportunities open for comment'; or by prior arrangement.

Objections to the proposal together with the grounds on which they are made must be sent in writing by 24th January 2020 to the Network Improvement Team, Transport for Buckinghamshire, Aylesbury Vale Area Office, Corrib Industrial Park, Griffin Lane, Aylesbury HP19 8BP; or by email to parkingtro@buckscc.gov.uk ; or online under 'about your council' then 'Have Your Say' then 'view all opportunities for comment'.

Dated 20th December 2019



QR code link to the
Buckinghamshire
County Council
'Have Your Say'
webpage

STATEMENT OF REASONS

THE BUCKINGHAMSHIRE COUNTY COUNCIL (WYCOMBE DISTRICT) (CONSOLIDATION) ORDER 2014 (* 201*) (AMENDMENT No. *) ORDER 201**

Buckinghamshire County Council has received a financial contribution through a Section 106 Highway Agreement for the implementation of a Traffic Regulation Order to introduce / amend parking restrictions in Barley Way and Malthouse Way. The contribution is made in respects of the new development in Portland Way and is made to mitigate any concerns relating to parking as a result of the new development.

The agreement is explicit and stipulates that the financial contribution is to be used in Malthouse Way and Barley Way for this purpose.

The Council have met with the Parish Council and Parking Services Team Leader and identified areas where additional parking restrictions would be of benefit to ensure the highway remains safe and accessible at all times.

The proposals intend to improve road safety by primarily restricting parking near to junctions and where visibility is reduced. The proposals will ensure that emergency vehicles and refuse collection vehicles can access all parts of the estate.



APPENDIX 1

THE BUCKINGHAMSHIRE COUNTY COUNCIL
(WYCOMBE DISTRICT) (CONSOLIDATION) ORDER 2014
(* 20) (AMENDMENT No. *) ORDER 20****

BUCKINGHAMSHIRE COUNTY COUNCIL (hereinafter referred to as “the Council”) in exercise of the powers under the Road Traffic Regulation Act 1984, (as amended) (“the Act”), and of all other enabling powers, and having regard to Section 122 of the Act and after consultation with the Chief Officer of Police in accordance with Part III of Schedule 9 to the Act, hereby make the following order:-

Commencement and citation:

1. This Order shall come into operation on XXXXXX and may be cited as “The Buckinghamshire County Council (Wycombe District) (Consolidation) Order 2014 (* 20**) (Amendment No. *) Order 20**”.

Amendments:

2. Without prejudice to the validity of anything done or to the liability incurred in respect of any act or omission before the coming into operation of this Order the Buckinghamshire County Council (Wycombe District) (Consolidation) Order 2014 (the 2014 Order) shall have effect.
 - a) The “Buckinghamshire County Council (Wycombe District) (Consolidation) Order 2014” is amended by the replacement of the plans specified below.

Area Code: Y95	Revision No.	*	Is replaced by	Revision No.	*
----------------	--------------	---	----------------	--------------	---

Rob Smith
Service Director, Highways and Technical Services

Authorised Signatory

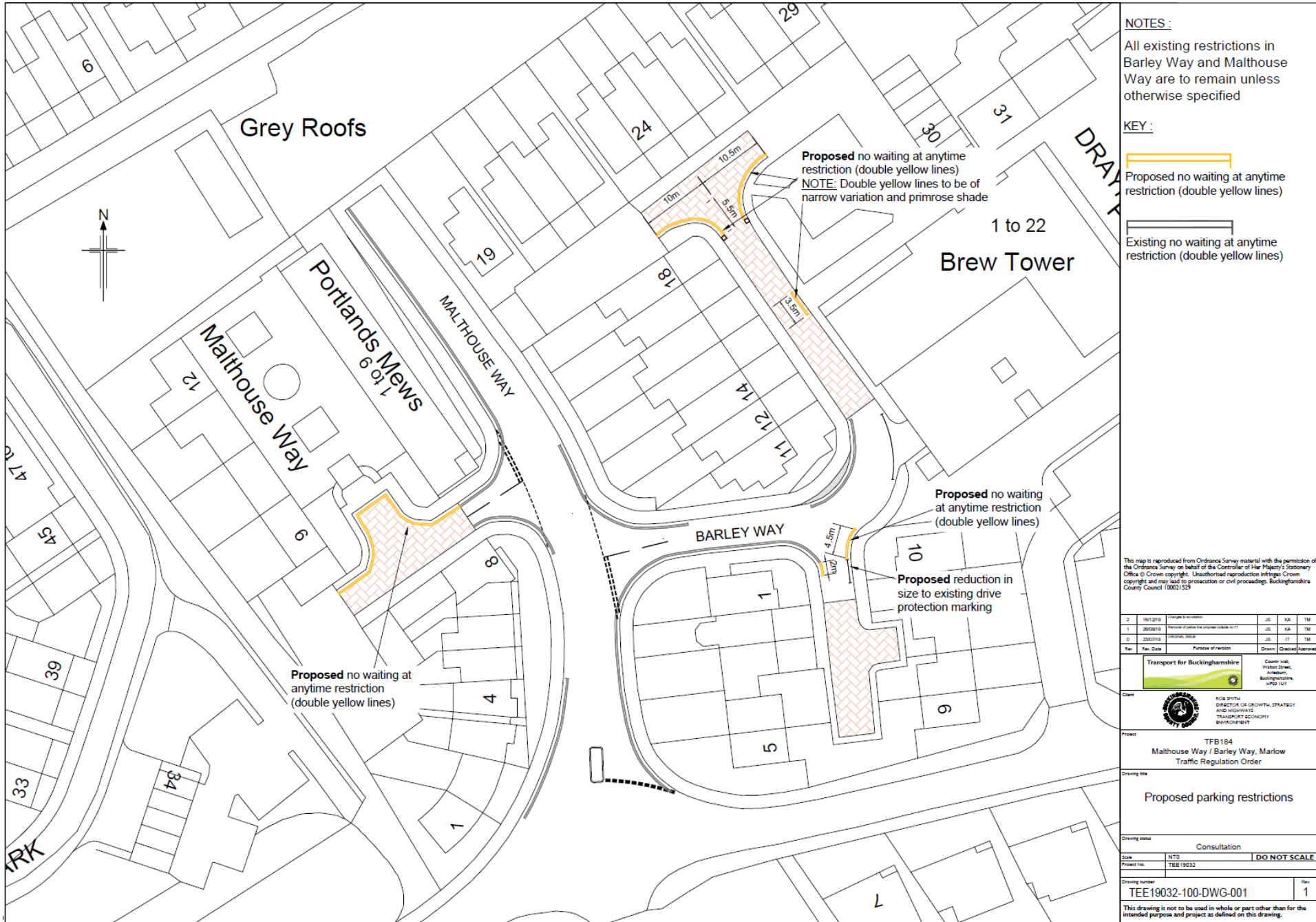

Dated:

APPENDIX 1



NOTES :
 All existing restrictions in Barley Way and Malthouse Way are to remain unless otherwise specified

KEY :

-  Proposed no waiting at anytime restriction (double yellow lines)
-  Existing no waiting at anytime restriction (double yellow lines)

This map is reproduced from Ordnance Survey material with the permission of the Ordnance Survey on behalf of the Controller of Her Majesty's Stationery Office © Crown copyright. Unauthorised reproduction infringes Crown copyright and may lead to prosecution or civil proceedings. Buckinghamshire County Council (0002152)

2	15/12/19	Changes to installation	JS	PA	TM
1	26/09/19	Review of plans for proposed installation	JS	PA	TM
0	23/07/19	Original Issue	JS	IT	TM

Rev	Rev. Date	Purpose of revision	Drawn	Checked	Approved

Client:  Transport for Buckinghamshire
 County Hall, Victoria Street, Aylesbury, Buckinghamshire, HP8 1UT

Project: TFB184
 Malthouse Way / Barley Way, Marlow
 Traffic Regulation Order

Drawing title: Proposed parking restrictions

Drawing status: Consultation

Date:	NTS	DO NOT SCALE
Project No.:	TEE19032	

Drawing number:	TEE19032-100-DWG-001	Rev:	1
-----------------	----------------------	------	---

This drawing is not to be used in whole or part other than for the intended purpose and project as defined on this drawing.