

Service provided by  
Oxford Health NHS Foundation Trust



**Buckinghamshire  
Mental Health Services**

# South Buckinghamshire Community Mental Health Hub

a state-of-the-art mental health hub at  
Easton Street, High Wycombe

*Care to make a difference locally*



# Teams currently based in South Bucks are to move to Easton Street, High Wycombe.

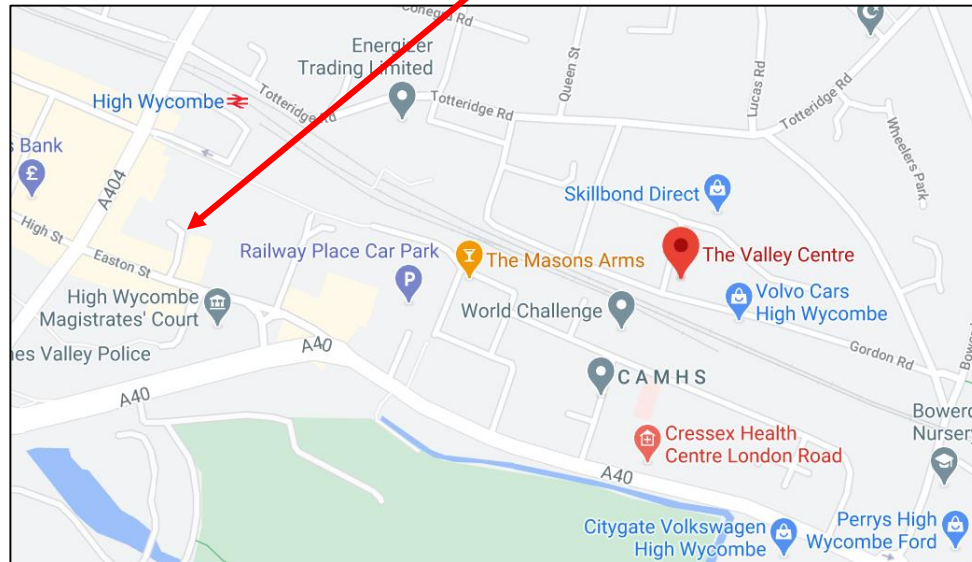

## The new hub means a move for teams *(indicative dates)*

In May/June 2021 teams will move from

- The Valley Centre
- Albert House

By June/July 2021 teams will move from

- Harlow House
  - Shrublands
- 

# Improvements for patients and public

- ✓ Services will be zoned with a separate entrance for our young people.
  - ✓ Improved accessibility and facilities
  - ✓ Improved parking
  - ✓ Centre of excellence for mental health in south Buckinghamshire
  - ✓ Reducing mental health stigma by greater visibility of services locally
- 

# Improvements for staff

---

- Better opportunities for joint working, promotion and learning
- Creating a centre of mental health excellence for South Bucks
- Improved parking
- Accessible site and bathroom facilities
- 24/7 refreshments
- Pioneer of trust's green strategy

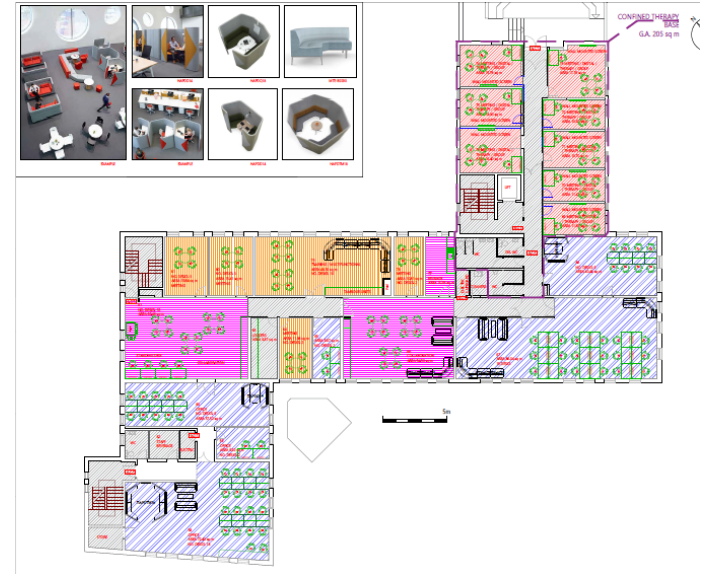

## Co-production with patients & staff to:

- ✓ name the centre and design reception
  - ✓ design artwork and gardens
  - ✓ Communications such as newsletters and leaflets
- 

# What does this mean for our estate?

- Four buildings into one
- Modern design
- New housing created
- Leasing from local authority and forging new partnerships
- A more efficient estate
- Future proofing



# Thank you joining us today

Further questions?

Want to share your views?

Email: [SouthBucksMHHub@oxfordhealth.nhs.uk](mailto:SouthBucksMHHub@oxfordhealth.nhs.uk)

Dedicated intranet pages via the Bucks pages...

