

APPENDIX A – Original junction layout prior to any works

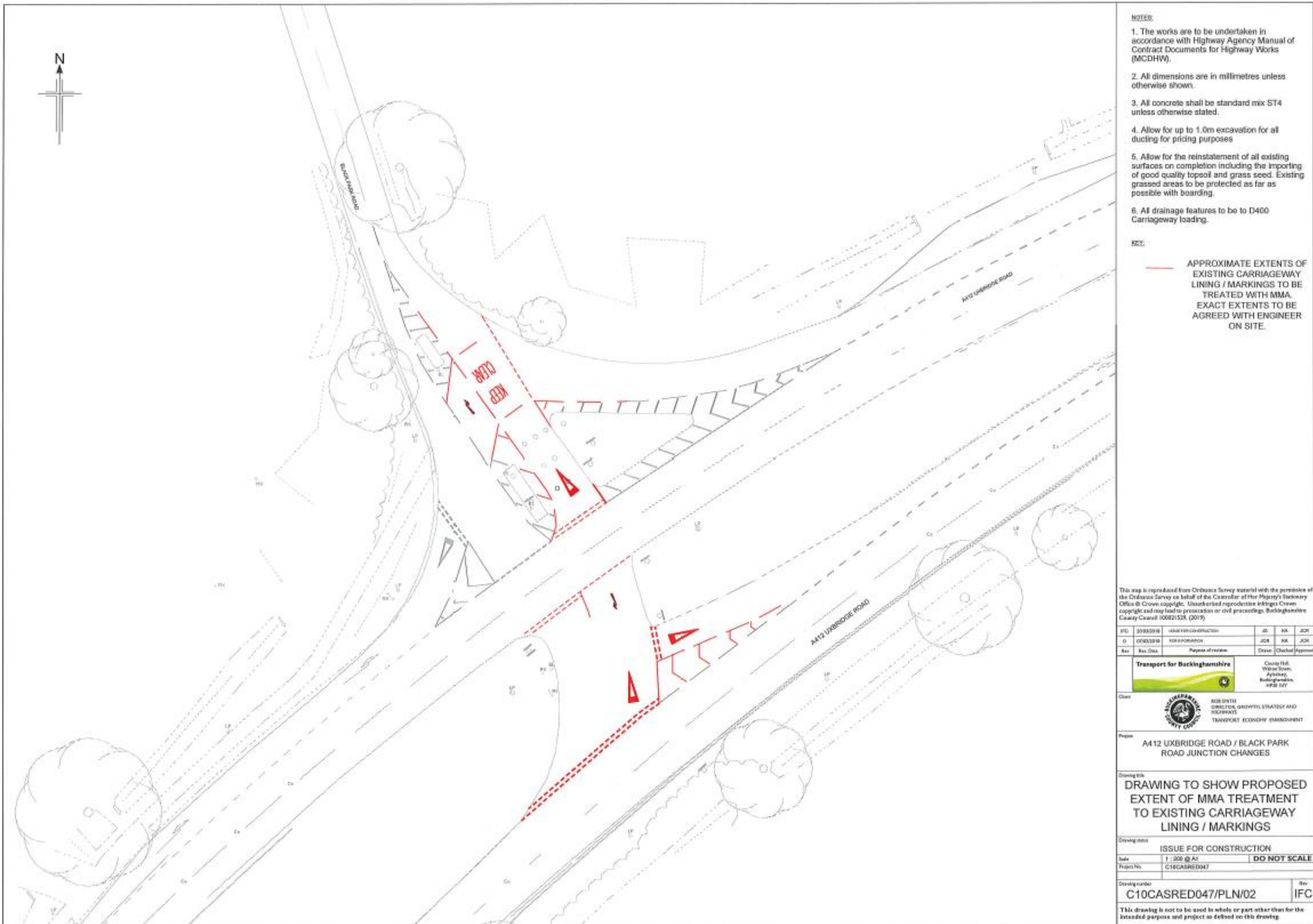

- NOTES:**
1. The works are to be undertaken in accordance with Highway Agency Manual of Contract Documents for Highway Works (MCDHW).
  2. All dimensions are in millimetres unless otherwise shown.
  3. All concrete shall be standard mix ST4 unless otherwise stated.
  4. Allow for up to 1.0m excavation for all ducting for pricing purposes
  5. Allow for the reinstatement of all existing surfaces on completion including the importing of good quality topsoil and grass seed. Existing grassed areas to be protected as far as possible with boarding.
  6. All drainage features to be to D400 Carriageway loading.

**KEY:**

— APPROXIMATE EXTENTS OF EXISTING CARRIAGEWAY LINING / MARKINGS TO BE TREATED WITH MMA. EXACT EXTENTS TO BE AGREED WITH ENGINEER ON SITE.

This map is reproduced from Ordnance Survey material with the permission of the Ordnance Survey on behalf of the Controller of Her Majesty's Stationery Office © Crown copyright. Unauthorised reproduction infringes Crown copyright and may lead to prosecution or civil proceedings. Buckinghamshire County Council 100821513. (2019)

Rev	Rev. Date	Reason for revision	Drawn	Checked	Approved
0	08/03/2019	ISSUE FOR CONSTRUCTION	JCR	SA	JCR

**Transport for Buckinghamshire**

County Hall,  
Windsor Street,  
Aylesbury,  
Buckinghamshire,  
HP8 1UT

**BUCKINGHAMSHIRE COUNTY COUNCIL**

ROB SMITH  
DIRECTOR, GROWTH, STRATEGY AND HIGHWAYS  
TRANSPORT ECONOMY ENVIRONMENT

**Project:** A412 UXBRIDGE ROAD / BLACK PARK ROAD JUNCTION CHANGES

**Drawing title:** DRAWING TO SHOW PROPOSED EXTENT OF MMA TREATMENT TO EXISTING CARRIAGEWAY LINING / MARKINGS

**Drawing issue:** ISSUE FOR CONSTRUCTION

Scale: 1:200 @ A1 **DO NOT SCALE**

Project No: C10CASRED047

**Drawing number:** C10CASRED047/PLN/02 **Rev:** IFC

This drawing is not to be used in whole or part other than for the intended purpose and project as defined on this drawing.

APPENDIX A – Junction layout following temporary measures and ETRO

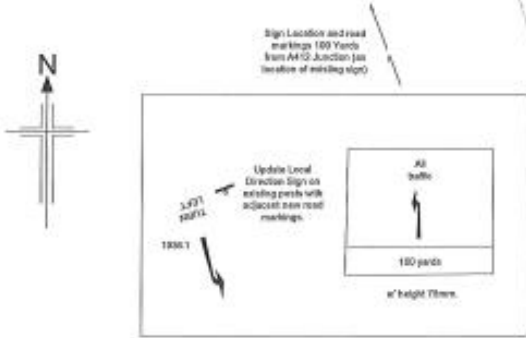
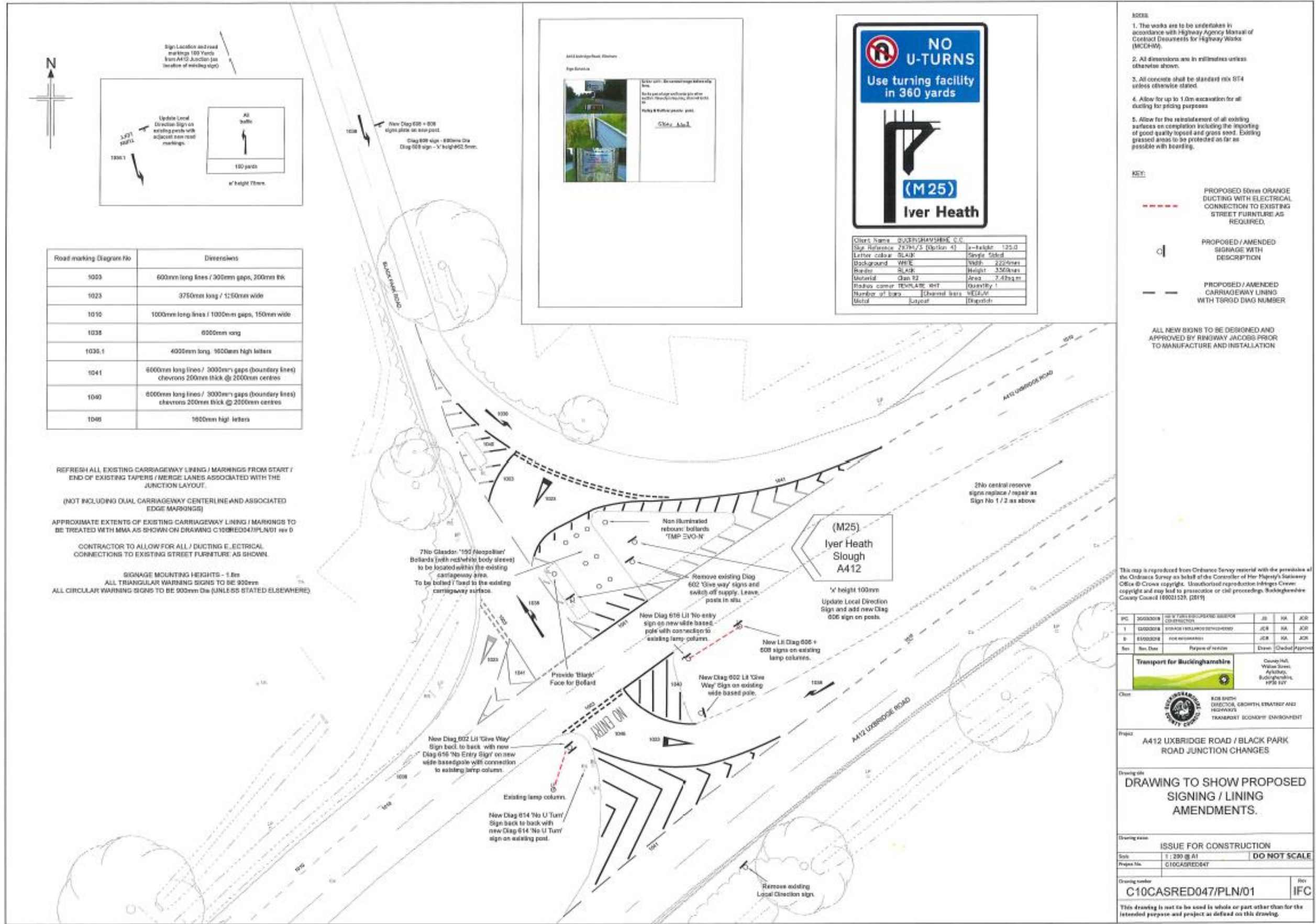

Road marking Diagram No	Dimensions
1003	600mm long lines / 300mm gaps, 200mm thick
1023	3750mm long / 1:50mm wide
1010	1000mm long lines / 1000mm gaps, 150mm wide
1038	6000mm long
1035.1	4000mm long, 1000mm high letters
1041	6000mm long lines / 3000mm gaps (boundary lines) chevrons 200mm thick @ 2000mm centres
1040	6000mm long lines / 3000mm gaps (boundary lines) chevrons 200mm thick @ 2000mm centres
1046	1000mm high letters

REFRESH ALL EXISTING CARRIAGEWAY LINING / MARKINGS FROM START / END OF EXISTING TAPER / MERGE LANES ASSOCIATED WITH THE JUNCTION LAYOUT.  
(NOT INCLUDING DUAL CARRIAGEWAY CENTERLINE AND ASSOCIATED EDGE MARKINGS)

APPROXIMATE EXTENTS OF EXISTING CARRIAGEWAY LINING / MARKINGS TO BE TREATED WITH MMA AS SHOWN ON DRAWING C10CASRED047/PLN/01 rev 0

CONTRACTOR TO ALLOW FOR ALL / DUCTING ELECTRICAL CONNECTIONS TO EXISTING STREET FURNITURE AS SHOWN

SIGNAGE MOUNTING HEIGHTS - 1.8m  
ALL TRIANGULAR WARNING SIGNS TO BE 900mm  
ALL CIRCULAR WARNING SIGNS TO BE 900mm Dia (UNLESS STATED ELSEWHERE)



NOTES:

- The works are to be undertaken in accordance with Highway Agency Manual of Contract Documents for Highway Works (MCDHW).
- All dimensions are in millimetres unless otherwise stated.
- All concrete shall be standard mix ST4 unless otherwise stated.
- Allow for up to 1.0m excavation for all ducting for pricing purposes.
- Allow for the reinstatement of all existing surfaces on completion including the importing of good quality topsoil and grass seed. Existing grassed areas to be protected as far as possible with boarding.

KEY:

- PROPOSED 50mm ORANGE DUCTING WITH ELECTRICAL CONNECTION TO EXISTING STREET FURNITURE AS REQUIRED.
- PROPOSED / AMENDED SIGNAGE WITH DESCRIPTION
- PROPOSED / AMENDED CARRIAGEWAY LINING WITH T890D DWG NUMBER

ALL NEW SIGNS TO BE DESIGNED AND APPROVED BY RINGWAY JACOBS PRIOR TO MANUFACTURE AND INSTALLATION

This map is reproduced from Ordnance Survey material with the permission of the Ordnance Survey on behalf of the Controller of Her Majesty's Stationery Office © Crown copyright. Unauthorised reproduction infringes Crown copyright and may lead to prosecution or civil proceedings. Buckinghamshire County Council 180021531, (2019)

Rev	Rev. Date	Purpose of revision	Drawn	Checked	Approved
1					
2					

Client: Transport for Buckinghamshire  
County Hall, Watlington, Aylesbury, Buckinghamshire, HP8 1UT

Client: BUCKINGHAMSHIRE COUNTY COUNCIL  
ROB SMITH, DIRECTOR, GROWTH, STRATEGY AND HIGHWAYS  
TRANSPORT, ECONOMY, ENVIRONMENT

Project: A412 UXBRIDGE ROAD / BLACK PARK ROAD JUNCTION CHANGES

Drawing title: DRAWING TO SHOW PROPOSED SIGNING / LINING AMENDMENTS.

Drawing issue: ISSUE FOR CONSTRUCTION

Scale: 1:200 @ A1 DO NOT SCALE

Project No: C10CASRED047

Drawing number: C10CASRED047/PLN/01 Rev: IFC

This drawing is not to be used in whole or part other than for the intended purpose and project as defined on this drawing.



APPENDIX A – Proposed measures following permanent TRO and permanent physical features

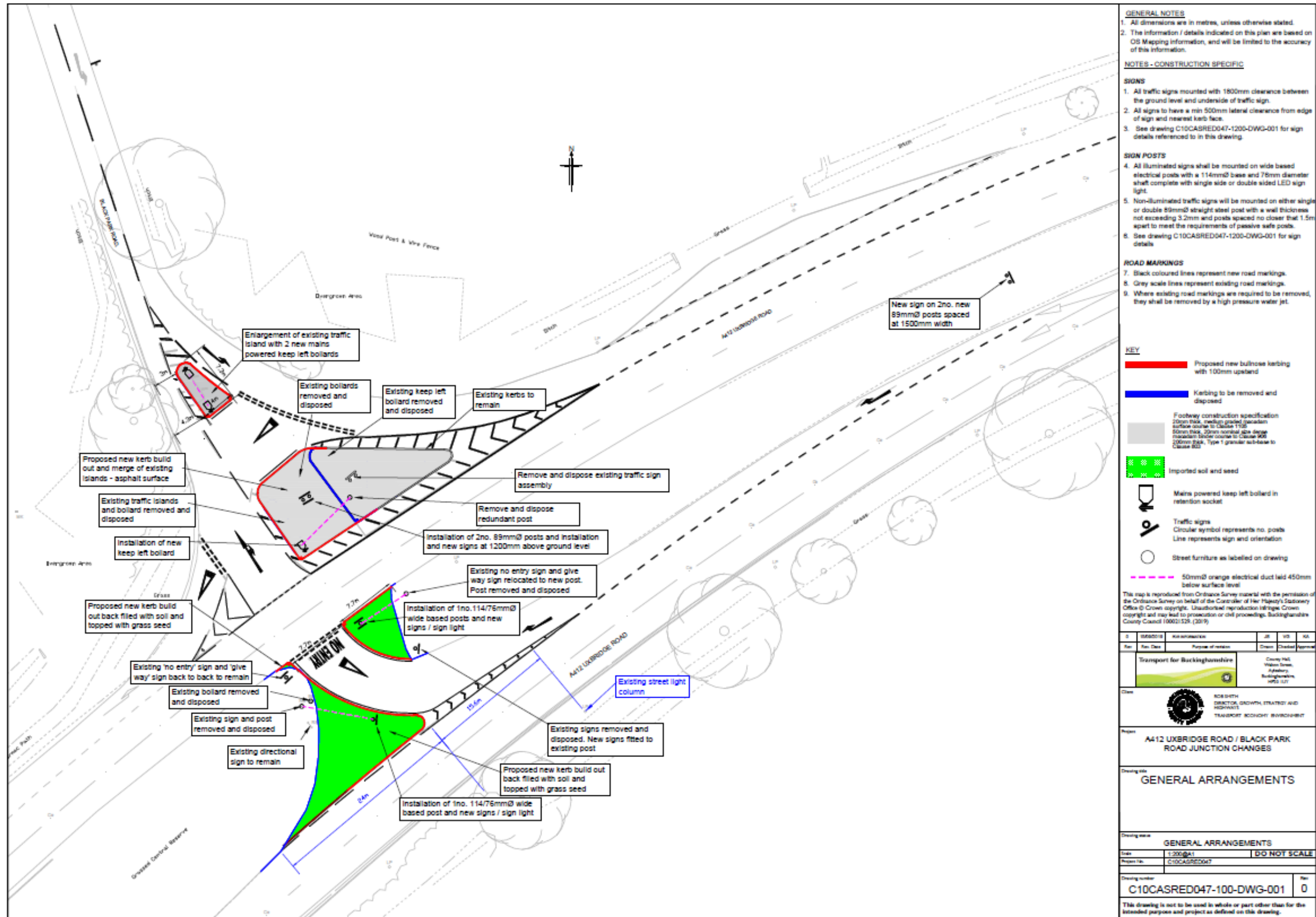

**GENERAL NOTES**

- All dimensions are in metres, unless otherwise stated.
- The information / details indicated on this plan are based on OS Mapping information, and will be limited to the accuracy of this information.

**NOTES - CONSTRUCTION SPECIFIC**

**SIGNS**

- All traffic signs mounted with 1800mm clearance between the ground level and underside of traffic sign.
- All signs to have a min 500mm lateral clearance from edge of sign and nearest kerb face.
- See drawing C10CASRED047-1200-DWG-001 for sign details referenced to in this drawing.

**SIGN POSTS**

- All illuminated signs shall be mounted on wide based electrical posts with a 114mmØ base and 78mm diameter shaft complete with single side or double sided LED sign light.
- Non-illuminated traffic signs will be mounted on either single or double 89mmØ straight steel post with a wall thickness not exceeding 3.2mm and posts spaced no closer than 1.5m apart to meet the requirements of passive safe posts.
- See drawing C10CASRED047-1200-DWG-001 for sign details.

**ROAD MARKINGS**

- Black coloured lines represent new road markings.
- Grey scale lines represent existing road markings.
- Where existing road markings are required to be removed, they shall be removed by a high pressure water jet.

**KEY**

- Proposed new bullnose kerbing with 100mm upstand
- Kerbing to be removed and disposed
- Footway construction specification: 200mm thick, medium graded granular surface course to Clause 1120; 100mm thick, 20mm nominal size dense granular binder course to Clause 906; 200mm thick, Type 1 granular sub-base to Clause 823
- Imported soil and seed
- Mains powered keep left bollard in retention socket
- Traffic signs: Circular symbol represents no. posts; Line represents sign and orientation
- Street furniture as labelled on drawing
- 50mmØ orange electrical duct laid 450mm below surface level

This map is reproduced from Ordnance Survey material with the permission of the Ordnance Survey on behalf of the Controller of Her Majesty's Stationery Office © Crown copyright. Unauthorised reproduction infringes Crown copyright and may lead to prosecution or civil proceedings. Buckinghamshire County Council 100021528 (2019)

Rev	Rev Date	Rev Description	Drawn	Checked	Approved
1	04/03/2021	Issue for construction			

County Hall, Milton Keynes, Aylesbury, Buckinghamshire, MK9 1JY

ROSEBETH DIRECTOR, GROWTH, STRATEGY AND HIGHWAYS  
 TRANSPORT ECONOMY ENVIRONMENT

**Project:** A412 UXBRIDGE ROAD / BLACK PARK ROAD JUNCTION CHANGES  
**Drawing title:** GENERAL ARRANGEMENTS  
**Drawing name:** GENERAL ARRANGEMENTS  
**Date:** 1/20/21 **Scale:** DO NOT SCALE  
**Project No.:** C10CASRED047  
**Drawing number:** C10CASRED047-100-DWG-001 **Rev:** 0

This drawing is not to be used in whole or part other than for the intended purpose and project as defined on this drawing.